

IM5131

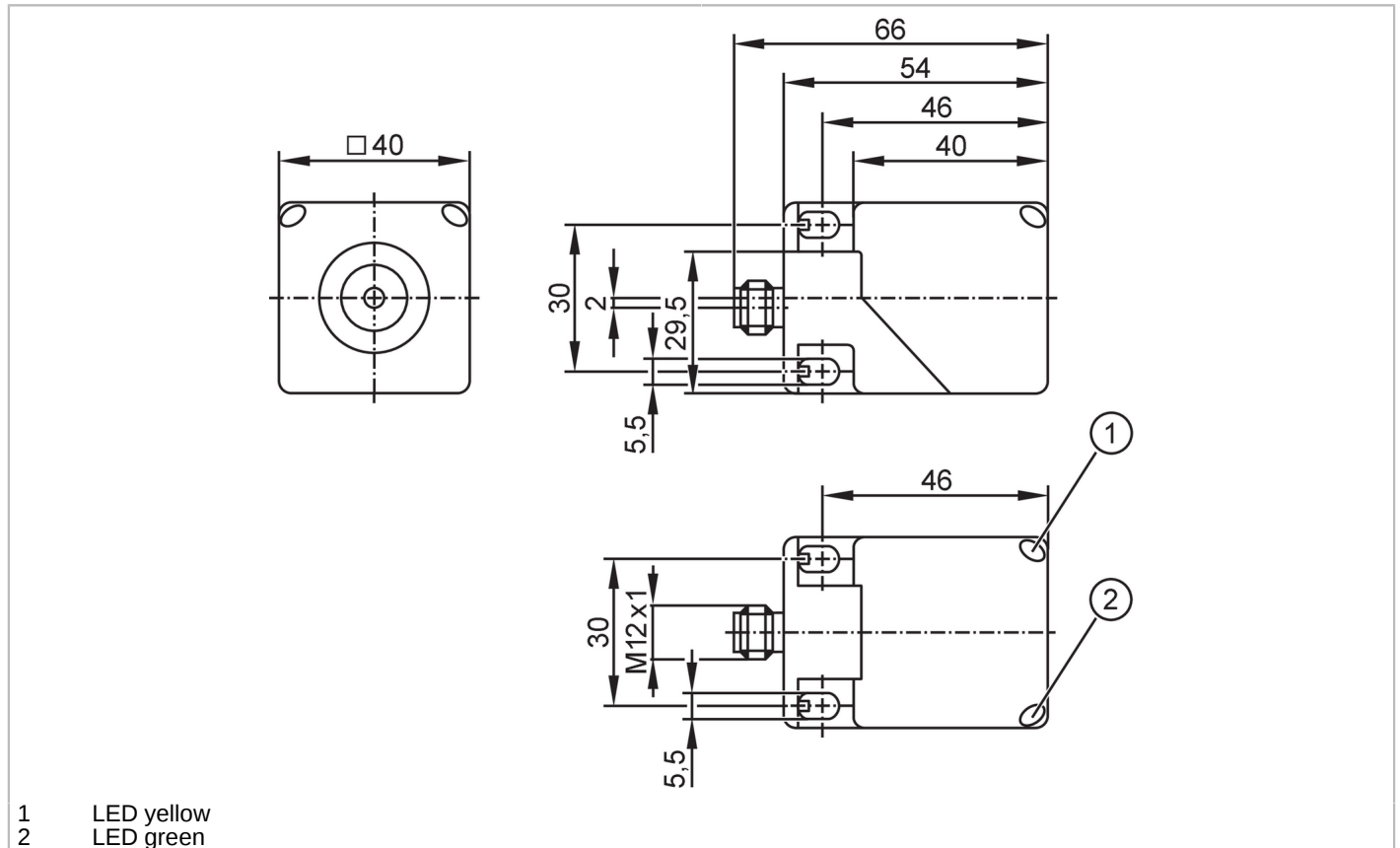

Inductive sensor

IMC3040-BPKG/K1/US-100-DPS



- 1 LED yellow
- 2 LED green



Product characteristics	
Electrical design	PNP
Output function	normally open
Sensing range [mm]	40
Housing	rectangular
Dimensions [mm]	40 x 40 x 54
Application	
Special feature	Correction factor K = 1; Magnetic-field immune
Magnetic-field immune	yes
Max. magnetic field immunity [mT]	300
Electrical data	
Operating voltage [V]	10...36 DC
Current consumption [mA]	< 20
Protection class	II
Reverse polarity protection	yes
Outputs	
Electrical design	PNP
Output function	normally open
Max. voltage drop switching output DC [V]	2.5

IM5131



Inductive sensor

IMC3040-BPKG/K1/US-100-DPS

Permanent current rating of switching output DC [mA]	200
Switching frequency DC [Hz]	200
Short-circuit protection	yes
Type of short-circuit protection	pulsed
Overload protection	yes

Detection zone		
Sensing range [mm]		40
Real sensing range Sr [mm]		40 ± 10 %
Operating distance [mm]		0...32.4

Accuracy / deviations		
Correction factor		steel: 1 / stainless steel: 1 / brass: 1 / aluminium: 1 / copper: 1
Hysteresis [% of Sr]		1...20
Switch point drift [% of Sr]		-10...10
Correction factor K = 1		yes

Operating conditions		
Ambient temperature [°C]		-25...70
Protection		IP 67

Tests / approvals		
EMC	EN 61000-4-2 ESD	8 kV CD / 6 kV AD
	EN 61000-4-3 HF radiated	10 V/m
	EN 61000-4-4 Burst	2 kV
	EN 61000-4-5 Surge	0,5 kV line to line, Ri: 2 Ohm
	EN 61000-4-6 HF conducted	10 V
	EN 55011	class B
MTTF [years]		1161
UL approval	Ta	-25...70 °C
	Enclosure type	Type 1
	voltage supply	Class 2
	File number UL	E174191

Mechanical data		
Weight [g]		132.5
Housing		rectangular
Sensing face		5 positions selectable
Mounting		non-flush mountable
Dimensions [mm]		40 x 40 x 54
Materials		housing: PA; sensing face: PA black; bevelled housing part: PA; clamp: orange; screw: stainless steel (304CU/1.4567)

Displays / operating elements		
Display	switching status	1 x LED, yellow
	operation	1 x LED, green

Remarks		
Pack quantity		1 pcs.

IM5131



Inductive sensor

IMC3040-BPKG/K1/US-100-DPS

Electrical connection - plug

Connector: 1 x M12; coding: A; Contacts: 4; Locking: locking, rotatable, stainless steel (316L/1.4404)



Connection

