



Position sensors

# Show your colours! Multi-colour touch sensors with IO-Link



Touch sensors



Ergonomic working by softly touching the sensor

Start-up delay prevents unintentional switching

Various setting options such as colour, NO/NC or triggering via IO-Link

Adjustable brightness and sensitivity in wet environments or when operators wear gloves

Plant condition indicated via RGB LEDs

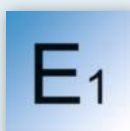
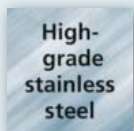

## Versatile sensor for all applications

The new multi-colour touch sensors from ifm allow flexible adaptation to your application. Where many different sensors were required before, one individually adjustable sensor is sufficient today. The NO/NC function or the colours for different operating states can be set within seconds. In addition, dynamic, static or bistable switching of the sensor can be selected.

## Adaptable to the environment

The adjustable sensitivity allows use in very wet environments or actuation with gloves. The implemented delay time prevents unintentional switching of a sensor. All settings remain stored even if the sensor is used without IO-Link. The sensor also counts the switching cycles for demand-oriented maintenance of the machine.



Type	Total length / thread [mm]	Connection	Protection	Ambient temperature [°C]	Housing material	Order no.
<b>Multi-colour touch sensor · IO-Link</b>						
	39 M22 x 1.5	2 m, PUR cable	IP 65 / IP 67 front: IP 69K	-40...85	plastic PA	<b>KT6100</b>
	39 M22 x 1.5	0.3 m PUR cable / M12 connector	IP 65, IP 67 front: IP 69K	-40...85	plastic PA	<b>KT6101</b>
	39 M22 x 1.5	2 m, PUR cable	IP 65, IP 67 front: IP 69K	-40...85	stainless steel 1.4305 (303 S 22)	<b>KT6300</b>
	39 M22 x 1.5	0.3 m PUR cable / M12 connector	IP 65, IP 67 front: IP 69K	-40...85	stainless steel 1.4305 (303 S 22)	<b>KT6301</b>

## Accessories

Type	Description	Order no.
<b>Touch sensor</b>		
	Symbol disc, transparent, 2 pcs	<b>E12386</b>
	Symbol disc, lettering: START, 2 pcs	<b>E12377</b>
	Symbol disc, symbol: Start / Stop, 2 pcs	<b>E12468</b>
	Symbol disc, lettering: STOP, 2 pcs	<b>E12378</b>
	Symbol disc, symbol: Up / Down, 2 pcs	<b>E12469</b>
	Symbol disc, symbol: ON, 2 pcs	<b>E12379</b>
	Symbol disc, symbol: OFF, 2 pcs	<b>E12380</b>

## IO-Link

	IO-Link master with PROFINET interface	<b>AL1100</b>
	IO-Link master with EtherNet/IP interface	<b>AL1120</b>
	USB IO-Link master for parameter setting and analysis of units Supported communication protocols: IO-Link (4.8, 38.4 and 230 Kbits/s)	<b>E30390</b>
	LR DEVICE (supplied on USB flash drive) Software for online and offline parameter setting of IO-Link sensors and actuators	<b>QA0011</b>

## Further technical data

Operating voltage	[V DC]	24, (10...30)
Current consumption	[mA]	30
Current rating	[mA]	200
Short-circuit protection		•
Reverse polarity protection / overload protection		• / •
Illumination		circular on the upper side
LED states		can be configured
Communication via IO-Link		illumination colour, illumination intensity, switching characteristics, output function, electrical design, sensitivity

## Insertable symbol discs

Different symbol discs can be inserted into the front to give the operator an easy explanation of the function of the touch sensors.

## Dimensions

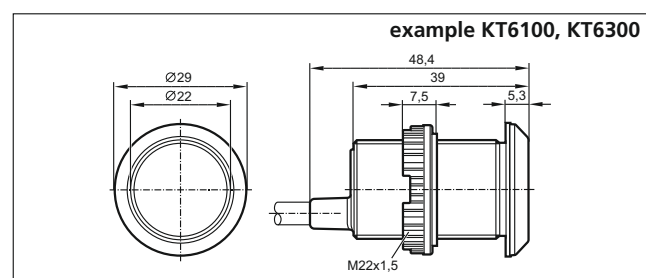

## Wiring diagram



KT6100, KT6300

KT6101, KT6301