

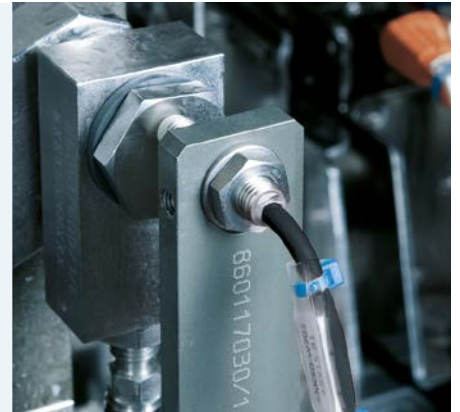

Position sensors

They could hardly be smaller: inductive sensors in M8 design



Inductive sensors



Compact dimensions enable their use in a confined space

Robust design, sensing face also available in stainless steel

Sealed: protection ratings IP 65 to IP 69K

Wide temperature range for universal use

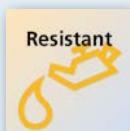
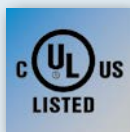
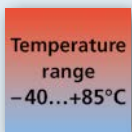
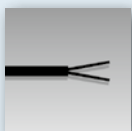

Light, small and powerful

The extremely compact housing has its strength wherever there is restricted space for sensors or where the additional mass is to be kept low: In factory automation, on machine tools or on fast moving robot arms the miniature sensor scores with a range that is almost as long as that of larger designs.

Ready for every application

The high-grade stainless steel housing makes the sensor extremely resistant, the temperature range from -40 to 85 °C and the protection class IP 65 to IP 69K open up almost unlimited application possibilities. The LED switching status indication is easy to read even in places where access is difficult.



Type	Total length [mm]	Sensing range [mm]	Installation [mm]	Electrical design	Switching output	Order no.
3-wire · full metal sensor · sensing face of high-grade stainless steel · LED in cable end part · PUR connection cable						
M8 x 1	37.5	2	flush	PNP	NO	IEC213
M8 x 1	37.5	2	flush	PNP	NC	IEC214
M8 x 1	37.5	2	flush	NPN	NO	IEC215
M8 x 1	37.5	2	flush	NPN	NC	IEC216
3-wire · stainless steel sleeve · sensing face LCP natural · LED in cable end part · PUR connection cable						
M8 x 1	27.5	3	flush	PNP	NO	IES238
M8 x 1	27.5	6	non flush	PNP	NO	IES239
M8 x 1	27.5	3	flush	PNP	NC	IES240
M8 x 1	27.5	6	non flush	PNP	NC	IES241
M8 x 1	27.5	3	flush	NPN	NO	IES242
M8 x 1	27.5	6	non flush	NPN	NO	IES243
M8 x 1	27.5	3	flush	NPN	NC	IES244
M8 x 1	27.5	6	non flush	NPN	NC	IES245
2-wire · stainless steel sleeve · sensing face LCP natural · LED in cable end part · PUR connection cable						
M8 x 1	27.5	3	flush	PNP / NPN	NO	IES246
M8 x 1	27.5	6	non flush	PNP / NPN	NO	IES247

Dimensions

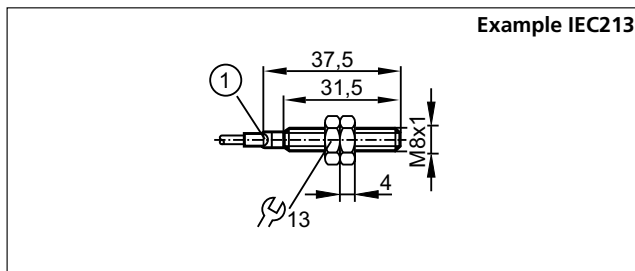

1) LED yellow

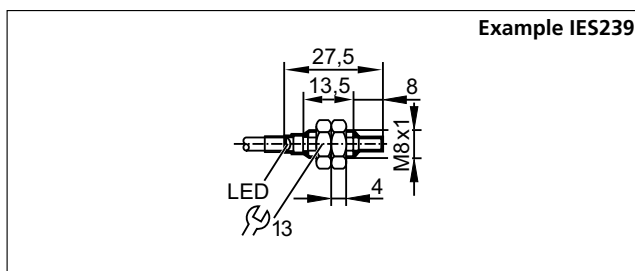
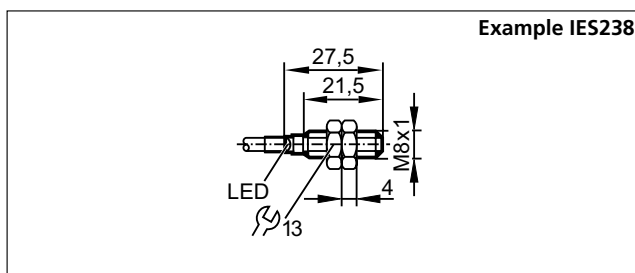

Further technical data

Operating voltage [V]	10...30
Current consumption [mA]	< 10
Short-circuit protection	yes
Reverse polarity protection	yes
Protection rating	IP 65, IP 66, IP 67, IP 68, IP 69K
Protection class	II
Ambient temperature [°C]	-40...85
Housing material	sensing face: LCP natural or stainless steel, housing: stainless steel, LED window: PEI
Switching status indication	4 x LED yellow
Connection cable	2 m PUR 3 x 0.14 mm ²

Accessories

Type	Description	Order no.
	Angle bracket M8	E10734
	Mounting clamp	E11521