



Position sensors

Extremely robust from head to cable: compact full-metal sensors



Inductive sensors



**Short and compact also
in cable version: ideal for
tight spaces**

**Sealed: protection ratings
IP 65 to IP 69K**

**Anti-spatter coating for
welding applications**

**Sensing face resistance to
impacts of up to 1 joule**

**Reliable at temperature
range from -40...85 °C**

IP 67
IP 68
IP 69 K

Temperature
range
-40...+85°C

Resistant

Resistant

High-grade
stainless
steel

High-grade
stainless
steel

High reliability even under extreme conditions

Full-metal sensors are used wherever an application requires special resistance, e.g. when it comes to coping with important stress factors in industrial applications such as lathes or milling machines. Here, the sensor housing has to reliably withstand rapid changes of temperature and aggressive media such as lubricants and coolants. Moreover, the robust high-grade stainless steel design offers optimum protection against abrasive parts in metal-cutting machining.

In the steel industry or in automotive industry, however, it is weld spatter, that presents a strain on the sensor housing. Here, the design with non-stick coating combined with the impact resistant sensing face is the ideal solution to ensure safe operation. The compact and short design permits use even in the smallest of spaces.



Type	Total length [mm]	Sensing range [mm]	Electrical design	Housing material / sensing face	Connection	Order no.
------	----------------------	-----------------------	-------------------	------------------------------------	------------	--------------

Suitable for industrial, mobile, cooling and lubricating applications

M12 x 1	40	4 flush	PNP, NO	Stainless steel (316L / 1.4404)	2m PUR cable	IFC278
M18 x 1	40	8 flush	PNP, NO	Stainless steel (316L / 1.4404)	2m PUR cable	IGC261
M30 x 1.5	45	15 flush	PNP, NO	Stainless steel (316L / 1.4404)	2m PUR cable	IIC237

Suitable for welding applications

M12 x 1	40	4 flush	PNP, NO	Stainless steel (316L / 1.4404), anti-spatter	2m PUR cable	IFR212
M18 x 1	40	8 flush	PNP, NO	Stainless steel (316L / 1.4404), anti-spatter	2m PUR cable	IGR212
M30 x 1.5	45	15 flush	PNP, NO	Stainless steel (316L / 1.4404), anti-spatter	2m PUR cable	IIR212

Dimensions

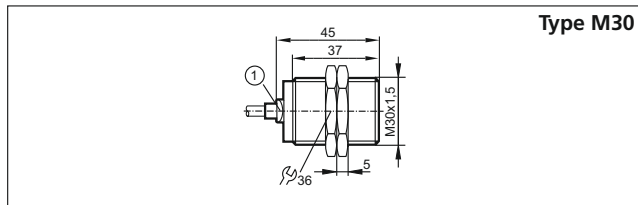
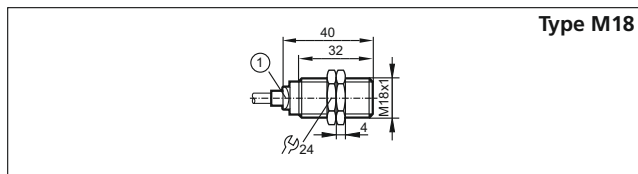
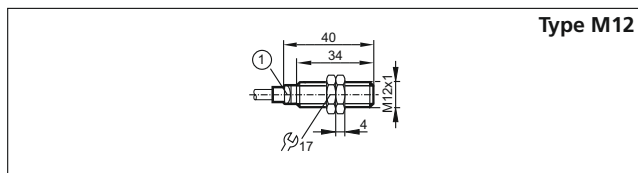

1) LED yellow

Connection technology

Type	Description	Order no.
	Socket, M12, 4-pole, wirable	EVC810
	Socket, M12, 4-pole, wirable	EVC811
	Cable plug, M12, 4-pole, wirable	EVC812
	Cable plug, M12, 4-pole, wirable	EVC813

We reserve the right to make technical alterations without prior notice. · 11.2019

ifm – close to you!

Common technical data

Correction factors		Steel: 1; Stainless steel: 0.7; Brass: 0.6; Aluminium: 0.5; Copper: 0.2
Operating voltage	[V DC]	10...30
Current consumption	[mA]	< 20
Reverse polarity protection		•
Short-circuit protection		•
Voltage drop	[V]	< 2.5
Current rating	[mA]	100
Ambient temperature	[°C]	-40...85
Protection rating		IP 67...IP 69k
Protection class		III
Switching status indication	LED	yellow
Housing materials		diecast zinc with special coating; Sensing face: LCP natural; LED window: TPU; Potting: PUR
Operating status indication	LED	yellow, in cable end part

Accessories

Type	Description	Order no.
	Angle bracket for type M12, stainless steel	E10735
	Angle bracket for type M18, stainless steel	E10736
	Angle bracket for type M30, stainless steel	E10737
	M12 washers, anti-spatter, 2 pcs	E12412
	M18 washers, anti-spatter, 2 pcs	E12413
	M30 washers, anti-spatter, 2 pcs	E12414

For further technical details please visit: ifm.com